

ANLAN

IPL HAIR REMOVER

User Manual

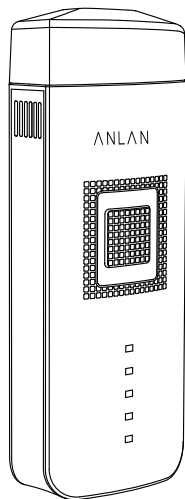

Dear Customer, please read this user manual carefully before use. Please keep this user manual after reading for future reference. Please attach this user manual when transferring this product to others.

Warnings

1. The device is only intended for domestic or private use, but not for commercial use.
2. The device is only suitable for people over 18 years old.
3. Children must not play with the device.
4. Before each use, check the integrity of the appliance and the power cord.
5. The device must not be put into service if it is damaged.
6. Do not use the device near baths, sinks, showers or other containers containing water or other liquids - risk of electric shock!
7. Always make sure the device is stable and level.
8. Never look at the laser.
9. Do not insert any object into the ventilation slots of the device.
10. Make sure that the ventilation slots on the unit are not covered.

Safety tips

Before using the device, read the safety instructions carefully and follow them exactly if you are using an ANLAN IPL hair removal device. Failure to observe the following may result in personal injury or property damage. Keep these operating instructions and make them accessible to other users. Make sure this manual is included if you pass the device on to third parties.

1. Do not use ANLAN IPL hair removal device during pregnancy or while breastfeeding.
2. If you notice extreme redness, blistering or burning on the skin, STOP USING IT IMMEDIATELY!
3. Perform a skin compatibility test on a small area of the skin in the planned treatment area 48 hours before using the ANLAN IPL hair removal device for the first time.
4. Never look directly at the light coming out of the cartridge. This product may emit dangerous optical radiation. Make sure the clear surface of the cartridge is completely in contact with the skin.
5. Never try to emit a pulse of light into the air!
6. Refer to the "hair and skin color chart", choose light intensities are best for your skin and hair color or if this method is right for you (if not, this is indicated by a "X" in the table).
7. Do not use the ANLAN IPL hair removal device on naturally dark skin or tanned skin or after 8. recent exposure. Treatment of dark skin with the ANLAN IPL hair removal device can have harmful consequences such as burns, blisters and changes in skin color (such as hypopigmentation).

9. The ANLAN IPL hair removal device works best on darker hair types or on hair that contains more melanin. Black and dark brown respond better and although brown and light brown hair also respond, they usually need more hair removal sessions. Red may show a reaction. ANLAN IPL hair removal device generally doesn't work on white, gray or blonde hair, although some users have noticed results after several hair removal sessions.
10. The ANLAN IPL hair removal device can cause temporary pigmentation.
11. Do not try to open or repair your ANLAN IPL hair removal device. When opening the ANLAN IPL hair removal device, you may come into contact with dangerous electrical components or with pulsed light energy, which can lead to serious injury or permanent eye damage.

Prohibited areas

Never use the ANLAN IPL hair removal device in the following areas:

- On the mucous membranes in the nose and ears.
- Above or next to an active implant such as a pacemaker, incontinence device, insulin pump, etc.
- On the face above the cheek, around the eyes, eyebrows or eyelashes, as this could cause serious eye damage.
- On the nipples, genitals (male or female) or around the anus.
- On piercings or other metallic objects, such as earrings or jewelry.
- On a tattoo or permanent makeup in the area to be treated.
- On brown or black spots, such as large freckles, moles, liver spots, blisters or warts.
- About eczema, psoriasis, lesions, open wounds or acute infections. Wait until the affected area has healed before using the ANLAN IPL hair removal device.
- On damaged or cracked skin or in places where there is a risk of malignancy.
- A part of the body where you may want to be hairy later.



Do not use ANLAN IPL hair removal device on tanned skin or after recent exposure to the sun!

Do not use ANLAN IPL epilator within 2 weeks of sun exposure (or more than 15 minutes of direct sunlight), as this can cause severe burns or skin damage. Treatment of skin that has recently been exposed to the sun can have harmful consequences such as burns, blisters and changes in skin color (hyper or hypopigmentation). Avoid direct exposure to the sun for more than 15 minutes at least 48 hours after treatment. If recently treated skin is exposed to the sun during this period, be sure to apply an SPF 30 or higher sunscreen.

Taboo

Do not use ANLAN IPL hair removal equipment if you are taking any of the following:

- If you are taking medicines that make the skin more sensitive to light, including nonsteroidal anti-inflammatory drugs (for example, aspirin, ibuprofen, paracetamol), tetracyclines, phenothiazines, thiazide diuretics, sulfonylureas, sulfonamides, DTIC, fluorouracil, vinblastine, alpha-griseofulvin Hydroxy acids (AHA), beta hydroxy acids (BHA), Retin-A®, Accutane® and / or topical retinoids.
- If you have recently been or are being treated with azelaic acid.
- If you have taken tetracycline antibiotics in the past two weeks.
- If you have been treated with Accutane® (isotretinoin) in the past 6 months.
- If you have been on a steroid diet in the past 3 months.
- If you have had a skin peel or other skin smoothing method in the past 6 to 8 weeks.
- If you have had radiation therapy or chemotherapy in the past 3 months.
- This list is not exhaustive. If you are unsure whether the ANLAN IPL hair removal device is safe for you, ask your doctor or dermatologist for advice.

Basic constitution

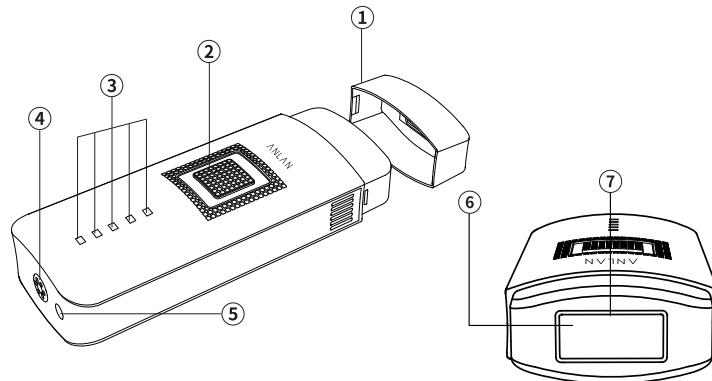

- ① Head cover
- ② Pulse button
- ③ Power level indicators
- ④ Power/energy button
 - ※ Click and hold for 3 seconds to turn on / off
 - ※ Click quickly to select the energy
- ⑤ Charging port
- ⑥ Built-in skin sensor
- ⑦ Glowing box

※ The ANLAN IPL epilator device cartridge has an integrated skin contact sensor to protect the eyes. There is no light pulse can be emitted when the contact sensor is not in contact with the skin. If no light pulse is seen, this indicates that the skin contact sensor does not have sufficient contact with the skin.

※ ANLAN IPL hair removal device cartridges have integrated UV protection to block harmful UV rays.

Product Information

Treatment area	4 cm ²
Technology	IPL (intense pulsed light) for home use
Wave length	530-1150 nm
Energy level	1.3-5.3J/cm ²
Selectable energy levels	5
Power supply	24V/2A
Speed	1 pulse every 1.4-3 seconds
Max. Pulses in light	50W
Package included	IPL AC Adapter Scraper Glasses Product Manual Flannel Bag

product information

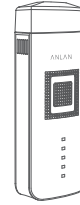

IPL Hair Remover*1

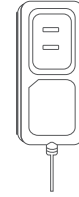

AC Adapter*1

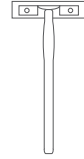

Scraper*1



Glasses*1

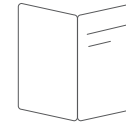

Product Manual*1

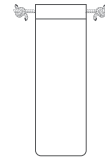

Flannel Bag*1

Definition

IPL laser hair remover is used to remove excess hair and can also permanently reduce hair growth. An IPL epilator can be used on different areas of the body: facial, legs, arms, armpits, around the lips, bikini areas.

Hair growth period

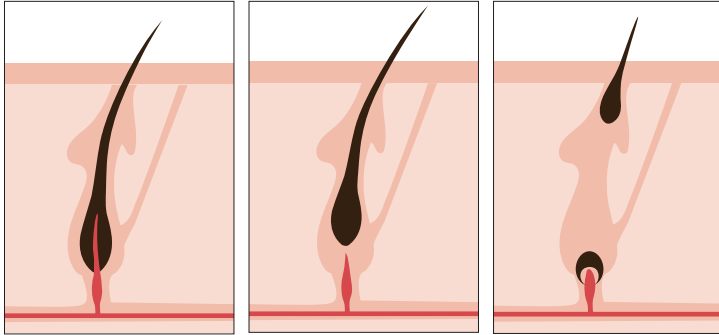

① Active growth phase

② Degradation phase

③ Resting phase

Each hair in our body goes through the three phases of the hair growth cycle:

active growth phase, degradation phase and resting phase.

These phases have a significant impact on IPL hair removal works:

the active growth phase is the hair growth phase, while the degradation phase and the resting phase are rest phases.

※ The length of a full hair growth cycle varies from person to person and depends on the body part of the hair, but is usually 18 to 24 months. At some point, the majority of hair follicles on the surface of the skin are in the resting phase.

The ANLAN IPL hair removal device is most effective when the hair is in the active growth phase.

※ It is important to note that a complete cycle of hair growth is necessary to obtain complete hair removal with the ANLAN IPL hair removal device.

Principle of operation

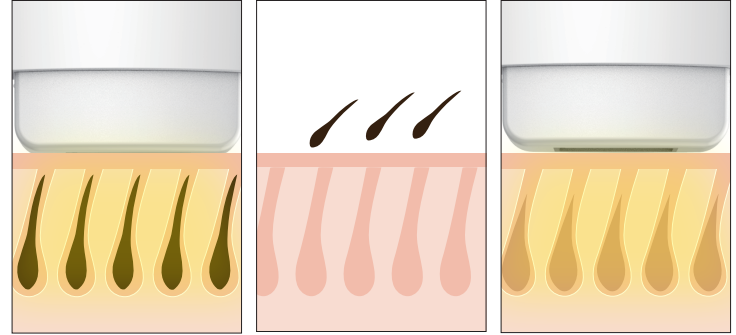

※ IPL stands for "Intense Pulsed Light". When the device is placed against the skin, gentle pulses of intense light are directed at the hair follicle to disable the hair root without affecting the surrounding area. The hair follicle is disabled as a result of lasting damage to the hair root. The light energy is absorbed by the melanin pigment in the hair to cause the rapid heating up of the hair follicle, and the heat destroys the cells responsible for hair growth. Eventually prevents new hair from growing.

※ IPL hair removal only works when the hair is in a special growth phase. For this reason, the results of an IPL treatment do not generally appear after the first use of the device. Instead, several treatments are usually needed to see the results.

Preparation before use

1. Compatibility

※ Before using the ANLAN IPL hair removal device for the first time, check whether the device is suitable for you. To check if the ANLAN IPL hair removal device is right for you, read "Warning and Safety Tips" and use the "Hair and Skin Color Chart" on the last page of the manual to determine which light intensities are right for you. better for your skin. and body hair and if this method is right for you (if not, this is indicated by an "x" in the table)

2. Skin tolerance test

- ※ Perform a skin compatibility test before using the ANLAN IPL hair removal device. The skin compatibility test is designed to determine how your skin reacts to treatment with the ANLAN IPL hair removal device. It also helps you define the optimal energy level for each treatment area. Perform a skin tolerance test on each skin area you wish to treat 48 hours before the full treatment.
- For facial treatments, the skin tolerance test should be performed on a hairless surface, such as under the ear or on the side of the neck.
- ① Before use, make sure the skin is shaved, clean and dry (free of residues such as powder, cream, makeup, antiperspirant or deodorant).
- ※ DO NOT wash the skin with flammable liquids such as alcohol or acetone shortly before using the ANLAN IPL hair removal device.
- ② Configure the device.
- ③ Place the clear surface of the cartridge on the desired test surface and make sure it is in full contact with the skin.
- ④ The appliance is automatically set to the lowest energy level. Trigger the first pulse with energy level 1 by pressing the trigger button. You will see a bright flash, hear a crackling sound, and may feel a slight burning sensation and / or a warming effect. The device is ready for the next pulse within 3 seconds.
- ⑤ Remove the device from the skin and place it in the next place on the test surface. Note Only increase the energy level if you are not uncomfortable with the energy level previous. If you are already uncomfortable with energy level 1, do not increase the energy level.
- ⑥ You can increase the energy level by 1 using the energy selection button. The energy control lamp lights up depending on the energy level selected.
- ⑦ Repeat steps 5 and 6 only if you feel good until you have reached the highest energy level 6. Stop the test if you feel uncomfortable as there is a risk of harmful consequences as energy levels increase. Stop the test immediately if you notice any side effects such as extreme redness or blistering.
- ⑧ Wait 48 hours and examine the treated area. If the skin in the treated area looks normal (no reaction or slight redness), you can continue with a full treatment at the highest energy level that you found comfortable during the test. If you notice extreme redness, swelling or blistering even at low energy levels, do not subject this area to a full treatment.
- ※ Do not perform a full treatment at an energy level that you have never tested before! Treat the tested area no earlier than 1 week after the test.

3. Plan

- ※ A typical hair growth cycle can last from 18 to 24 months. During this time, several sessions with the ANLAN IPL hair removal device may be necessary to obtain long-term hair removal. The effectiveness of hair removal varies from person to person and varies depending on the area of the body and hair color and how the ANLAN IPL hair removal device is used. The typical plan for hair removal with the ANLAN IPL hair removal device during a full hair growth cycle:
- ※ The first 3-4 epilation sessions with the ANLAN IPL epilation device should be spaced about two weeks apart.
- ※ The epilation sessions 5-7 with the ANLAN IPL epilation device should be spaced about four weeks apart.
- ※ After that, you will normally use the ANLAN IPL hair removal device from time to time and if necessary until long term results are obtained. This corresponds to the recommended treatment plan, which has been shown to achieve the best results. You can also design your personal treatment plan differently and still get satisfactory results.
- ※ If the same part of the body is treated more than once in two weeks, the results of hair removal will not improve.
- ※ Do not treat the same skin area more than once per hair removal session! Treating an area of the skin multiple times during a hair removal session can increase the likelihood of side effects. Try to avoid overlapping impulses.

4. Build trust

- ※ If the ANLAN IPL hair removal device is used in accordance with the instructions in this instruction manual, side effects and complications associated with the use of the ANLAN IPL hair removal device are rare. However, any cosmetic treatment, including those developed for home use, is associated with a certain risk. Therefore, it is important that you understand and accept the risks and complications that can arise with pulsed light hair removal systems for home use.

Complication	Probability of complication	Side effect	Probability of side effect
Effects of multiple use of pulsed light on the same skin area	Slightly	Slight skin irritation	Slightly
		Redness of the skin	Slightly
		Increased skin sensitivity	Slightly
		Skin injuries and burns	Rare
		Scarring	Rare
		Pigment changes	Rare
		Excessive redness and swelling	Rare
		infection	Negligible
Hematoma	Negligible		

Start Using

- ※ Shave the area of hair you want to treat with the IPL device.
- ※ During IPL hair removal, heat is created, which can cause charring or burning of the hair. It is necessary to shave with a razor before using the hair removal device. Before use, make sure the skin is shaved, clean and dry (free of residues such as powder, cream, makeup, antiperspirant or deodorant).
- ※ Please wear safety glasses before use.

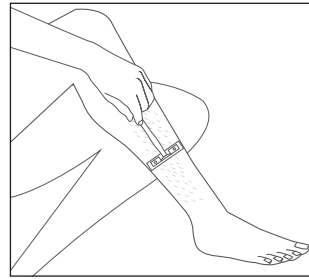

1. Use a razor to shave off the hair that needs to be removed.

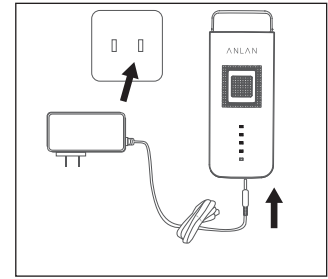

2. Plug the adapter into the socket. Connect the other end of the adapter to the IPL epilator.

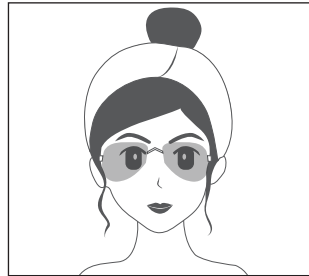

3. Wear the sunglasses.

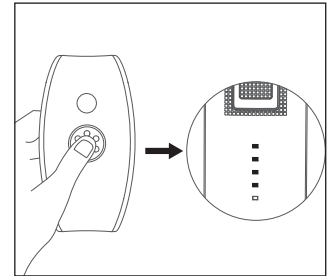

4. Press and hold for 3 seconds to turn on device. Click quickly to select the energy. The energy control lamp lights up depending on the energy level selected. From the top to the bottom is the first to fifth energy

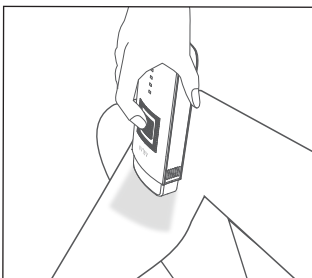

5. Fully touch the sensor's smooth surface to the skin to be depilated. When you press the button, the flash will light up, you hear a popping sound, and you may feel a slight burning or warming sensation.

 note	Do skin tolerance test 2 days in advance
	Choose the gear that suits you according to the results of previous skin tolerance tests.
	The ANLAN IPL hair removal device has a "flash glide" function. If you press and hold the button for 3 seconds, a bright flash will be triggered automatically every 3 seconds, so you do not have to press the release button every time.

- ※ Do not treat the same skin area more than once per hair removal session!
Treating an area of the skin multiple times during a hair removal session can increase the likelihood of side effects. Try to avoid overlapping impulses.
- ※ The pulses of the ANLAN IPL hair removal device must be applied in lines - starting at one end of each line and progressing to the other end. This technique allows better control of skin areas that have already been treated and helps you avoid treating the same area more than once or treating overlapping areas of skin.

After use

After treatment

- After using the ANLAN IPL device to finish epilation, tilt the device and press the power switch to turn off the device.
- Disconnect the power cord from the outlet.
- After each epilation, it is recommended that you clean the ANLAN IPL epilation device, especially the device surface.
- After cleaning, it is recommended to keep the ANLAN IPL hair removal device in its original box and away from water.

Beware of facial care

- Never use ANLAN IPL epilator on the face with the "flash-glide" function.
- Do not use ANLAN IPL hair removal device on the face above the cheekbones or on the eyes, eyebrows and eyelashes, as this can cause serious eye damage.
- Do not use ANLAN IPL hair removal device on the mucous membranes at the nose and ears.
- Facial hair can be hormonal, so several sessions may be necessary to permanently reduce hair.
- Avoid treating the nostrils and lips as these areas are more sensitive.
- You can "fold" your lips inwards or press them together to tighten the treatment area, or apply a thick white kohl pencil on the lips and the edge of the lips. This white line ensures that the energy of the flash is reflected and does not reach your lips when you accidentally direct a pulse towards the lips.

Facial care

- apply a soothing lotion such as aloe vera.
- Avoid using skin and whitening creams or similar products for at least 24 hours as this will irritate the treated skin.

- Avoid removing hair on the treated areas with wax or plucking. Keep in mind that it can take a full hair growth cycle for complete hair removal results to be available.

Questions and answers

Q. Is the ANLAN IPL hair removal device really effective?

A. Yes. Clinical tests by doctors have shown that the technology of the ANLAN IPL hair removal device can safely achieve long-term hair removal results.

Q. In which parts of my body can I use the ANLAN IPL hair removal device?

A. The ANLAN IPL hair removal device has been developed for full body hair removal. The most common areas treated with the ANLAN IPL hair removal device are the legs, armpits, arms, bikini line and face under the cheekbones.

Q. How long does a treatment session with the ANLAN IPL hair removal device last?

A. The time may vary depending on the area of the body to be treated. A full body treatment (legs, arms, armpits, bikini line and face under the cheekbones) takes approximately 26 minutes. Since the ANLAN IPL hair removal device works normally with electric current, it can be used as long as necessary to perform a complete hair removal session on the desired body part (s).

Q. Is the ANLAN IPL hair removal device safe?

A. The ANLAN IPL hair removal device has been designed for your safety and uses clinically tested technology. However, this device, like any other product or electronic device intended for use on the skin, must be used in accordance with the instructions for use and the safety information for users.

Q. Does the ANLAN IPL hair removal device cause pain?

A. When used correctly, most users of the ANLAN IPL hair removal device report that they feel a slight sensation of warmth when the light pulse is given. Users with thicker, darker hair may experience a little more discomfort, but this discomfort disappears after the hair removal session is over. The ANLAN IPL hair removal device has 5 power settings that you can use depending on your sensitivity.

Q. How often should I use the ANLAN IPL hair removal device?

A. When using ANLAN IPL hair removal equipment to treat hair, the first four lessons must be done every two weeks. The fifth to seventh sessions should be processed every four weeks. If the hair grows back, all other operations should be carried out until the desired effect is achieved.

When treating facial hair under the cheekbones, the first six sessions should be done every two weeks. The seventh to twelfth courses should be treated every four weeks. If the hair grows back, all other operations should be carried out until the desired result is obtained.

Q. Is the ANLAN IPL hair removal device effective for white, gray or blonde hair?

A. The quality of the IPL treatment depends mainly on the color of your hair and your skin type. Hair removal with light pulses works particularly well for people with fair skin and naturally darker hair. If your hair is gray, white, red, or extremely blonde, an IPL device usually has little or no effect. Similarly, an IPL hair removal device is not suitable for you if you have dark skin: the contrast between the hair and the dark skin is generally not enough to obtain an effect.

Q. Can I use the ANLAN IPL hair removal device on brown or black skin?

A. If you have dark skin, you can damage your skin with IPL technology. Because if the color of your skin is not really distinguishable from the hair color, the light can focus on your skin instead of your hair.

Q. When can I see the results of the ANLAN IPL hair removal device?

A. As with any light or laser hair removal device, the results are not immediately visible, and you might even think that nothing has happened. The appearance of hair sometimes grows back after a hair removal session, but generally, many of these hairs simply fall out after two weeks. In addition, hair grows in three different phases and only hair in the active growth phase is influenced by the ANLAN IPL hair removal device. This is one of the main reasons why several sessions are necessary to achieve the desired result.

Q. Can men use the ANLAN IPL hair removal device?

A. Although the ANLAN IPL hair removal device was developed for women, it may also be suitable for men. However, in men, usually those on the chest hair, the hair needs more hair removal sessions than women to achieve the desired results.

Q. Is the ANLAN IPL hair removal device effective for white, gray or blonde hair?

A. The quality of the IPL treatment depends mainly on the color of your hair and your skin type. Hair removal with light pulses works particularly well for people with fair skin and naturally darker hair. If your hair is gray, white, red, or extremely blonde, an IPL device usually has little or no effect. Similarly, an IPL hair removal device is not suitable for you if you have dark skin: the contrast between the hair and the dark skin is generally not enough to obtain an effect.

Q. Can I use the ANLAN IPL hair removal device on brown or black skin?

A. If you have dark skin, you can damage your skin with IPL technology. Because if the color of your skin is not really distinguishable from the hair color, the light can focus on your skin instead of your hair.

Q. When can I see the results of the ANLAN IPL hair removal device?

A. As with any light or laser hair removal device, the results are not immediately visible, and you might even think that nothing has happened. The appearance of hair sometimes grows back after a hair removal session, but generally, many of these hairs simply fall out after two weeks. In addition, hair grows in three different phases and only hair in the active growth phase is influenced by the ANLAN IPL hair removal device. This is one of the main reasons why several sessions are necessary to achieve the desired result.

Q. Can men use the ANLAN IPL hair removal device?

A. Although the ANLAN IPL hair removal device was developed for women, it may also be suitable for men. However, in men, usually those on the chest hair, the hair needs more hair removal sessions than women to achieve the desired results.

Guarantee

First of all, we hope you never need this warranty.

But we also want to offer you the best service, especially if the product has problems.

Our goal is to offer our customers the best products with first class quality and service. We guarantee return and modification within 30 days, free maintenance within 365 days and technical support at any given time.









If you are not satisfied or have any questions about the ANLAN product, please do not hesitate to contact us.

service@anlan.co

thank you,

ANLAN customer service

Skin color chart

hair / skin type	1	2	3	4	5	6
black 	energy 1-5		energy 1-4	energy 1-3		✗
dark brown 	energy 1-5		energy 1-4	energy 1-3		✗
brown 	energy 1-5		energy 1-4	energy 1-3		✗
dark blond 	energy 1-5		energy 1-4	energy 1-3		✗
blond 	energy 1-5		energy 1-4	energy 1-3		✗
light blond 	energy 1-5		energy 1-4	energy 1-3		✗
red 	energy 1-5		energy 1-4	energy 1-3		✗
grey/white 	✗	✗	✗	✗	✗	✗

※ Choose the energy level mainly based on your own well-being (after the skin tolerance test).
 ※ The higher the energy level, the more effective the treatment.