

**DEKO®****EN**

**INSTRUCTION MANUAL
DRYWALL SANDER
MODEL NO.:
DKWP180CD/DKWP180CDLD**
See page 1

**DKWP180CDLD****DKWP180CD**

**⚠ IMPORTANT: Read this instruction manual before operating this product.
Keep the instruction manual for future reference.**



DEKO TOOLS CO., LIMITED
www.dekools.com Made in China

General Power Tool Safety Warnings

⚠ WARNING: Read all safety warnings, instructions, illustrations and specifications provided with this power tool. Failure to follow all instructions listed below may result in electric shock, fire and/or serious injury.

Save all warnings and instructions for future reference.

The term "power tool" in the warnings refers to your mains-operated (corded) power tool or battery-operated (cordless) power tool.

1) Work area safety

- a) Keep work area clean and well lit. Cluttered or dark areas invite accidents.
- b) Do not operate power tools in explosive atmospheres, such as in the presence of flammable liquids, gases or dust. Power tools create sparks which may ignite the dust or fumes.
- c) Keep children and bystanders away while operating a power tool. Distractions can cause you to lose control.

2) Electrical safety

- a) Power tool plugs must match the outlet. Never modify the plug in any way. Do not use any adapter plugs with earthed (grounded) power tools. Unmodified plugs and matching outlets will reduce risk of electric shock.
- b) Avoid body contact with earthed or grounded surfaces, such as pipes, radiators, ranges and refrigerators. There is an increased risk of electric shock if your body is earthed or grounded.
- c) Do not expose power tools to rain or wet conditions. Water entering a power tool will increase the risk of electric shock.
- d) Do not abuse the cord. Never use the cord for carrying, pulling or unplugging the power tool. Keep cord away from heat, oil, sharp edges or moving parts. Damaged or entangled cords increase the risk of electric shock.
- e) When operating a power tool outdoors, use an extension cord suitable for outdoor use. Use of a cord suitable for outdoor use reduces the risk of electric shock.
- f) If operating a power tool in a damp location is unavoidable, use a residual current device (RCD) protected supply. Use of an RCD reduces the risk of electric shock.

3) Personal safety

- a) Stay alert, watch what you are doing and use common sense when operating a power tool. Do not use a power tool while you are tired or under the influence of drugs, alcohol or medication. A moment of inattention while operating power tools may result in serious personal injury.
- b) Use personal protective equipment. Always wear eye protection. Protective equipment such as a dust mask, non-skid safety shoes, hard hat or hearing protection used for appropriate conditions will reduce personal injuries.
- c) Prevent unintentional starting. Ensure the switch is in the off-position before connecting to power source and/or battery pack, picking up or carrying the tool. Carrying power tools with your finger on the switch or energizing power tools that have the switch on invites accidents.
- d) Remove any adjusting key or wrench before turning the power tool on. A wrench or a key left attached to a rotating part of the power tool may result in personal injury.
- e) Do not overreach. Keep proper footing and balance at all times. This enables better control of the power tool in unexpected situations.
- f) Dress properly. Do not wear loose clothing or jewellery. Keep your hair and clothing away from moving parts. Loose clothes, jewellery or long hair can be caught in moving parts.
- g) If devices are provided for the connection of dust extraction and collection facilities, ensure these are connected and properly used. Use of dust collection can reduce dust-related hazards.
- h) Do not let familiarity gained from frequent use of tools allow you to become complacent and ignore tool safety principles. A careless action can cause severe injury within a fraction of a second.

4) Power tool use and care

- a) Do not force the power tool. Use the correct power tool for your application. The correct power tool will do the job better and safer at the rate for which it was designed.
- b) Do not use the power tool if the switch does not turn it on and off. Any power tool that cannot be controlled with the switch is dangerous and must be repaired.
- c) Disconnect the plug from the power source and/or remove the battery pack, if detachable, from the power tool before making any adjustments, changing accessories, or storing power tools. Such preventive safety measures reduce the risk of starting the power tool accidentally.
- d) Store idle power tools out of the reach of children and do not allow persons unfamiliar with the power tool or these instructions to operate the power tool. Power tools are dangerous in the hands of untrained users.
- e) Maintain power tools and accessories. Check for misalignment or binding of moving parts, breakage of parts and any other condition that may affect the power tool's operation. If damaged, have the power tool repaired before use. Many accidents are caused by poorly maintained power tools.
- f) Keep cutting tools sharp and clean. Properly maintained cutting tools with sharp cutting edges are less likely to bind and are easier to control.
- g) Use the power tool, accessories and tool bits etc. in accordance with these instructions, taking into account the working conditions and the work to be performed. Use of the power tool for operations different from those

intended could result in a hazardous situation.

h) Keep handles and grasping surfaces dry, clean and free from oil and grease. Slippery handles and grasping surfaces do not allow for safe handling and control of the tool in unexpected situations.

5) Service







a) Have your power tool serviced by a qualified repair person using only identical replacement parts. This will ensure that the safety of the power tool is maintained.

Safety Rules for Sanders

- 1) **Disconnect the sander from power source before changing accessories. Accidental start-ups may occur if the sander is plugged in changing an accessory.**
- 2) **Use clamps or other practical way to secure and support the workpiece to a stable platform.** Holding the work by hand or against your body is unstable and may lead to loss of control.
- 3) **If your tool is equipped with a dust bag, empty it frequently and after completion of sanding.** Be extremely careful of dust disposal, materials in fine particle form may be explosive. Do not throw sanding dust on an open fire. Spontaneous combustion, may in time, result from mixture of oil or water with dust particles.
- 4) **Always wear eye protection and a dust mask for dusty applications and when sanding overhead.** Sanding particles can be absorbed by your eyes and inhaled easily and may cause health complications.
- 5) **Use special precautions when sanding chemically pressure treated timber paint that may be lead based or any other materials that may contain carcinogens.** A suitable breathing respirator and protective clothing must be worn by all persons entering the work area. Work area should be sealed by plastic sheeting and persons not protected should be kept out until work area is thoroughly cleaned.
- 6) **Remove dust and other waste matter in an environmentally safe way**
- 7) **Do not wet sand with this sander.** Liquids entering the motor housing are an electrical shock hazard.
- 8) **Do not use sandpaper intended for larger sanding or pads.** Larger sandpaper will extend beyond the sanding pad causing snagging or tearing of the paper or kick-back. Extra paper extending beyond the sanding pad can also cause serious lacerations.
- 9) **Keep handles dry, clean and free from oil and grease.** Slippery hands cannot safely control the power tool.

Symbol Explanation

In this manual and/or on the machine the following symbols are used:

	<p>Denotes risk of personal injury or damage to the tool.</p>
	<p>Read instruction manual before use.</p>
	<p>Conforms to relevant legislation and safety standards.</p>
	<p>Do not dispose of power tools and batteries/rechargeable batteries into household waste! Dispose the products according to the regulation and requirement of local council.</p>
	<p>Double insulation. Class II device. The device must not be earthed.</p>
	<p>Wear hearing protection. Wear eye protection. Wear breathing protection.</p>

Product Descriptions

Technical Data

Rated Voltage	230-240V
Frequency	50Hz
Rated Power	900W
No-Load Speed:	1400-2700r/min
Sanding Pad Dimensions	Φ180mm

Structure Overview

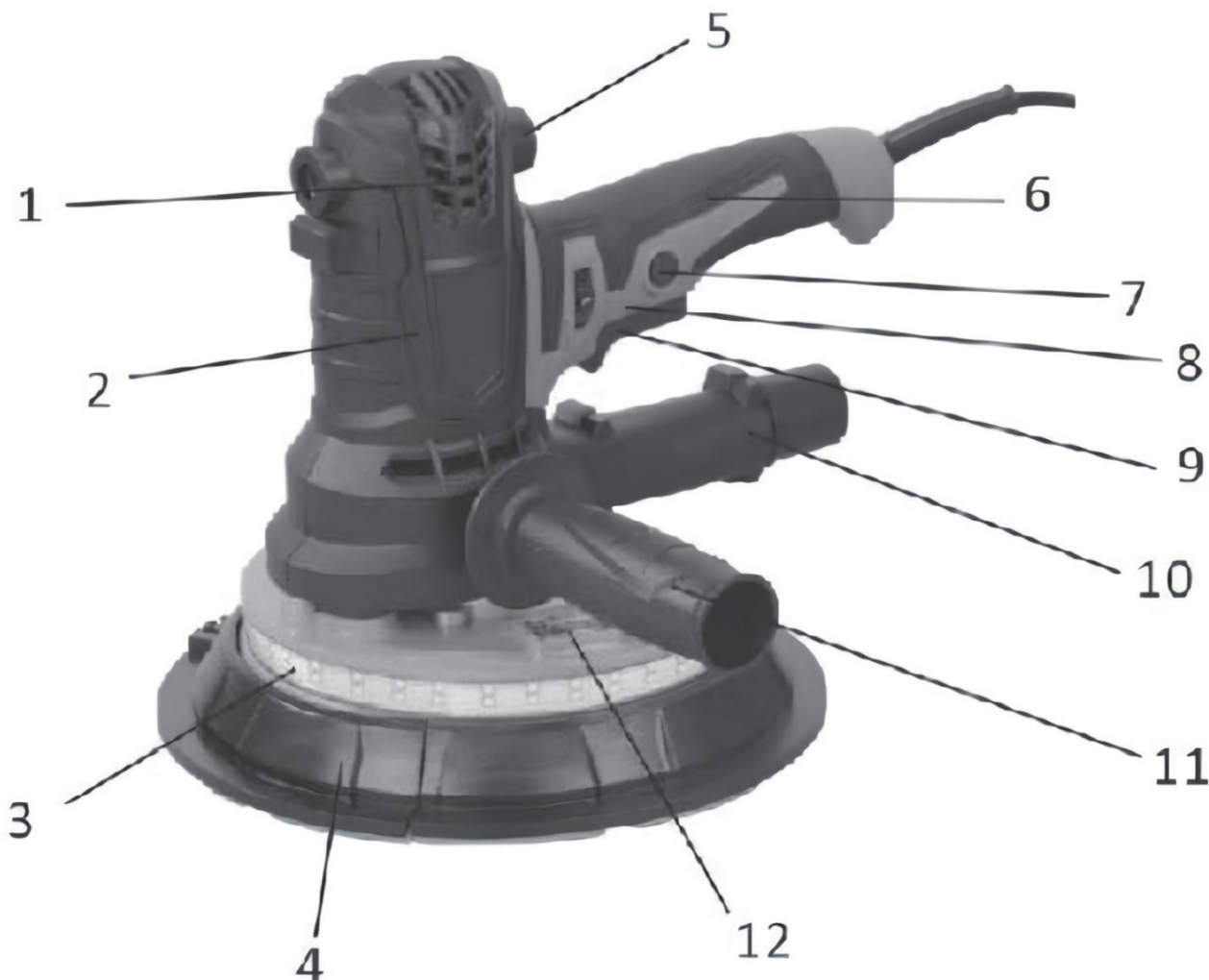

- 1 Heat sink at the top
- 2 High-power motor
- 3 Double LED strip light
- 4 180mm rotating adhibit tray
- 5 External carbon brush
- 6 Soft hand grip
- 7 Lock-on button
- 8 Speed control switch
- 9 On/off switch
- 10 Connector for dust collect bag
- 11 Side handle
- 12 LED strip light switch

NOTE: DKWP180CD doesn't have LED strip light.

Operation

Switch & speed governor operation

This drywall sander switch is self-locking, it can be locked in the "Opposition".

Just press the main switch button, it can work.

When press the switch button and the self-locking button, the switch will be locked. So users don't need to press

the switch button all the time.

When turn off the machine, users only need to press the main switch button, no need to press the self-locking button again on the machine.

As shown in Figure, governor can be adjusted easily to operate and also can improve the work quality.

Starting motor will produce a strong current, which will cause great damage to the equipment and not safe. So this machine is designed with soft start, using uniform start, which causes little damage to the motor and also greatly improves the safety.



Installation & Sandpaper Replacement

NOTE: Before installation or removing the sandpaper, please turn off the device and cut off the power supply.

Installation Guide

To ensure the replacement procedures, place the device on the smooth ground before installation. Take the sandpaper from the toolbox, and then fix it onto the disk (see Fig). The back of the sandpaper (Item 1) will automatically glue with the disk/adhesive disk (Item 2), making both connection and conduction available.

In order to promote the grinding efficiency, it is necessary to change the sandpaper after the device has been operational for a certain period. Firstly, switch off the device and disconnect the socket. Then, remove the previous sandpaper entirely from the disk, so as to lay new sandpaper neatly as well as facilitate future replacement. At last, fix new sandpaper in position.

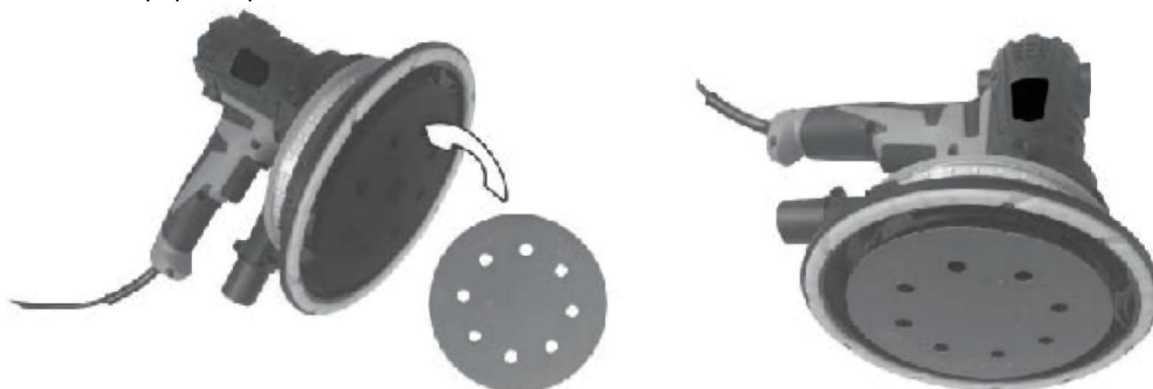

Sandpaper Overview

Grinding towards the target wall and object is possible with abrasive grains and sandpaper twisting upon operation. The sandpaper is classified into various categories according to its dimensions. It is recommended to select the sandpaper in accordance with actual size of the disk. The more abrasive grains included on the sandpaper, the better flatness and parallelism can be achieved via grinding, while the grinding efficiency will fall accordingly and vice versa. Therefore, the sandpaper($\Phi 180\text{mm}$) is recommended upon actual needs.

Replacement of the round sanding pad

In the using if the sanding pad have been broken you can ask our company for new sanding pad.

Taking off the sandpaper, using the wrench put into the holes in the center of the sanding pad, and slackening clockwise to take off the old sanding pad, install the new sanding pad.

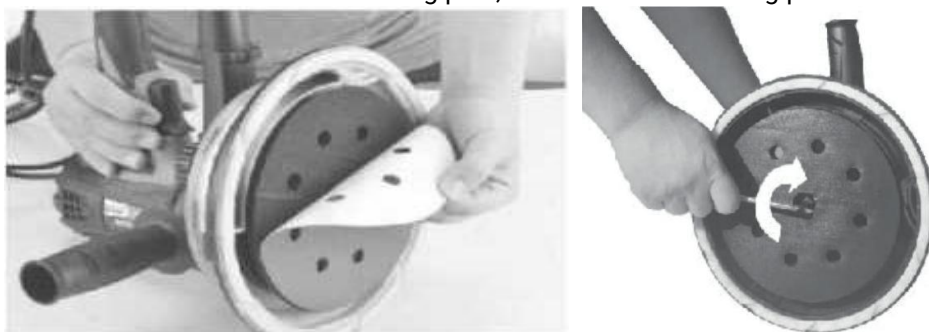

Sanding of the corner



Take off one part of the disassemble cover of the sanding pad (Part 8)

Sanding the corner space



• 360 Rotatable grinding disc-
Easy for ceiling polishing & edging grinding
It's much better to sanding the corner space with 360 degree Rotating Disassembled Part.

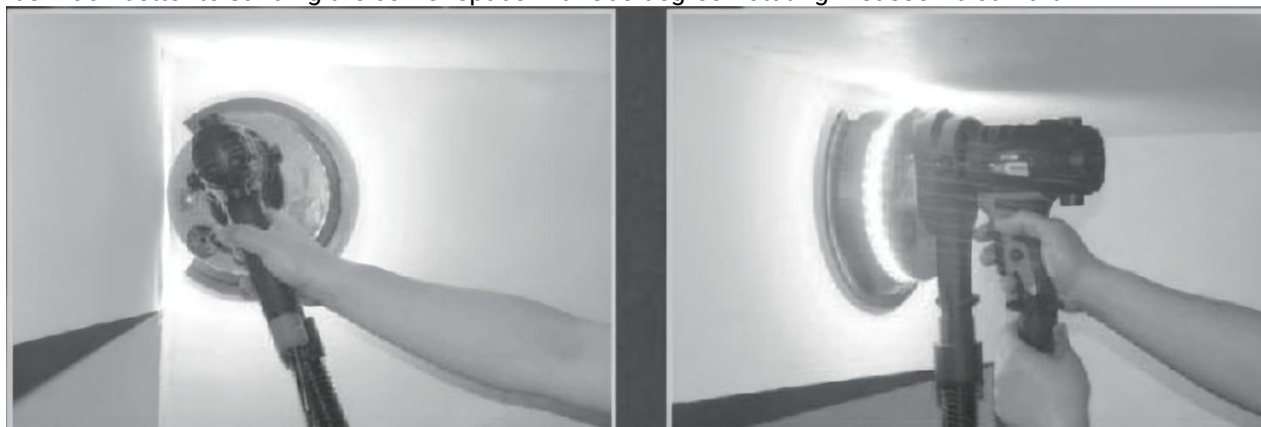

The suction can be adjusted

If the sander cannot be absorbed down on the wall due to air pressure during operation, users can rotate the switch to deflate and remove the sander.



Replacement of carbon brush

When the original carbon brush is worn, the machine has a set spare carbon brush for replacement.

Guide for the replacement of carbon brush:

- 1) Use the screwdriver to open the cover of the carbon brush and take out the carbon brush.
- 2) Put the spare carbon brush into the Brush Carrier, use the screwdriver to rotate and fix the cover of carbon brush tightly.

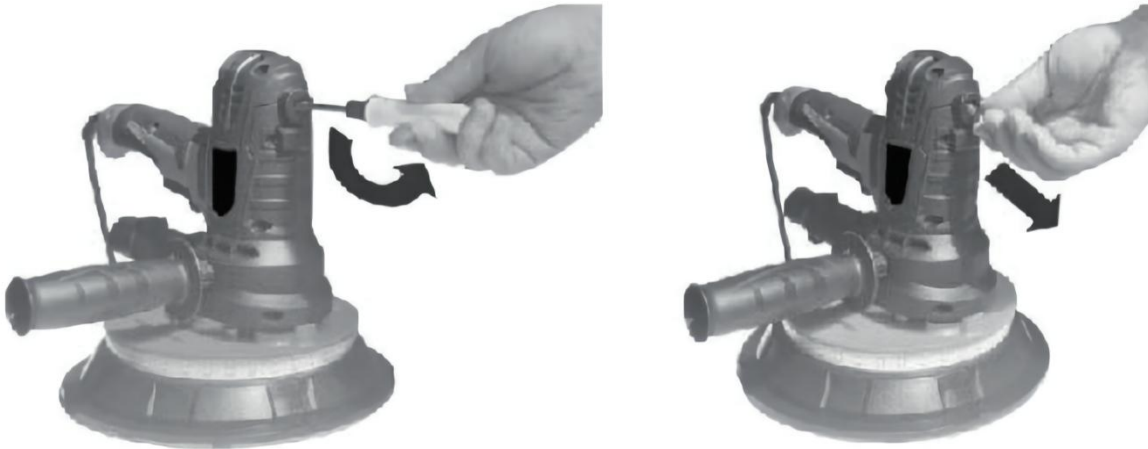

Dust collection

⚠ WARNING: To reduce the risk of injury, turn unit off and disconnect it from power source before installing and removing accessories, before adjusting or when making repairs. An accidental start-up can cause injury. Remove coated dust particles from the premises daily. The accumulation of fine sanding dust particles may self ignite and cause fire.

NOTE: To use your vacuum cleaner with the dust collection system, remove the dust bag by twisting and pulling away from the adapter. Attach dust extraction connector to dust outlet port and slide the suction mouth of a vacuum cleaner onto the connector.

Cleaning

Regular cleaning shall be conducted after grinding.

Cleaning the devices frequently may help to extend operating life and reduce repair rate. It is recommended to clean the connection sets and components of electric motor without application of water.

Timely cleaning is recommended after the application of the devices.

Clean the devices with a hairbrush and a piece of dry cloth, or simply blow it with high pressure gas.

Maintenance

The machine does not require any special maintenance.

Keep the ventilation slots of the tool and dust box clean at all times. If possible, prevent foreign matter from entering the vents.

After each use, blow air through the tool housing to ensure it is free from all dust particles that may build up. Build up of dust particles may cause the tool to overheat and fail.

If the enclosure of the tool requires cleaning, do not use solvents but a moist soft cloth only. Never let any liquid get inside the tool; never immerse any part of the tool into a liquid.

⚠ WARNING: Do not use cleaning agents to clean the plastic parts of the tool. A mild detergent on a damp cloth is recommended. Water must never come into contact with the tool.

Disposal



The machine and packaging should be sorted for environmental-friendly recycling. Do not dispose of power tools into household waste! Please recycle them at collection points provided for the purpose. Ask your local authority for information about recycling.